



CALVIN L. RAMPTON  
**SALT PALACE**  
CONVENTION CENTER  
A SALT LAKE COUNTY FACILITY



# Calvin L. Rampton Salt Palace Convention Center

- Nearly one million square feet (987,000) of convention center space.
- 515,000 square feet of contiguous exhibit space.
- 67 concurrent meeting spaces with 164,000 square feet of space.
- Gold Level Events Industry Council Sustainable Event Standards Certification (EIC SES).
- Onsite and exclusive catering provided by Centerplate.
- Onsite and preferred audio visual services provided by Encore Global.
- Opening Fall 2022:** Attached full-service convention center hotel with over 700 rooms.
- High quality internet services with leading-edge infrastructure and multiple carriers.
- Utah is a right-to-work state.

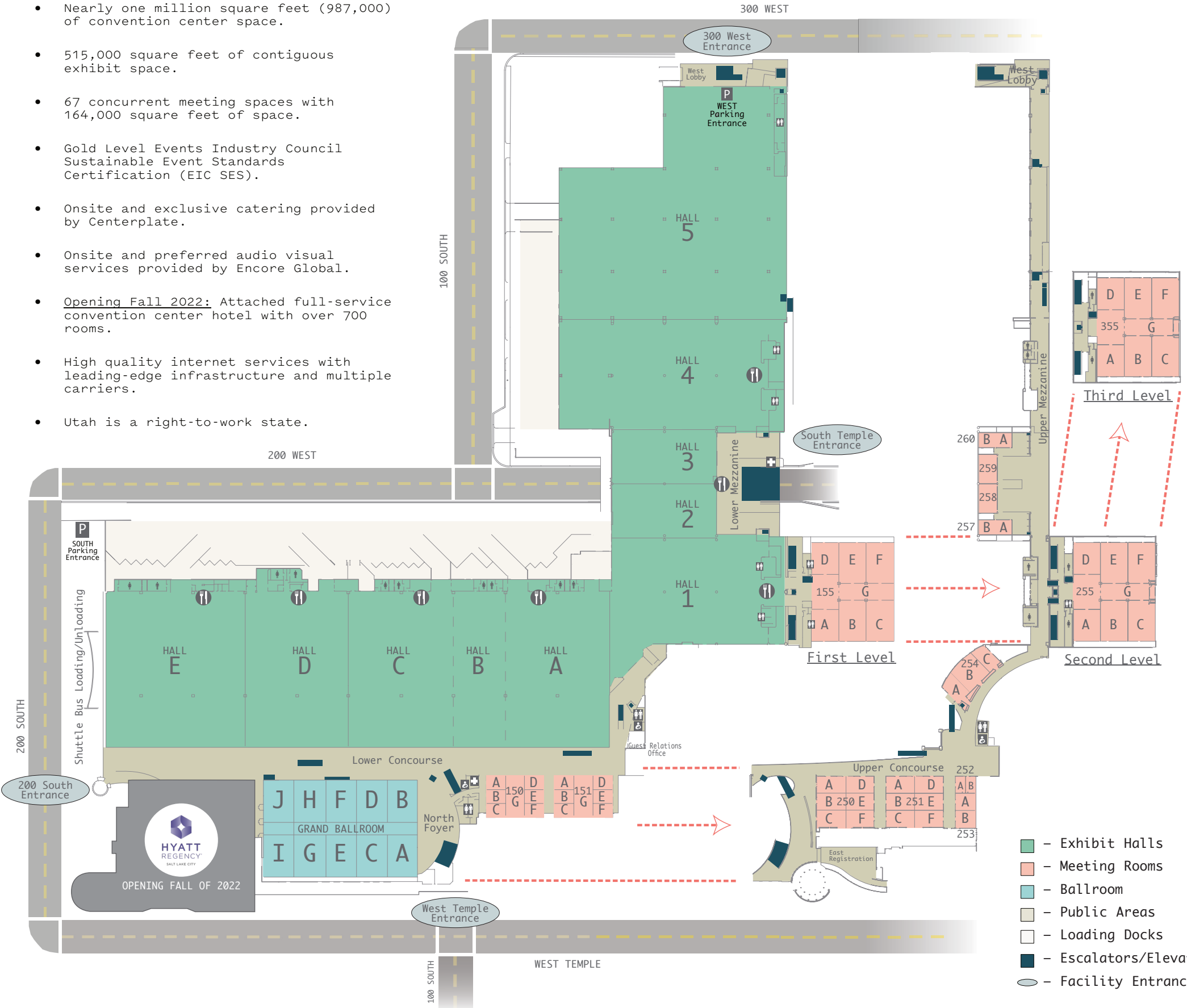

## Exhibit Halls

ROOM	SQ. FT.	Theatre	Banquet	Classroom	Ceiling
Exhibit Hall A	48,600	5,300	2,700	2,700	30'
Exhibit Hall B*	24,300	2,600	1,350	1,300	30'
Exhibit Hall C	48,600	5,300	2,700	2,700	30'
Exhibit Hall D	48,600	5,300	2,700	2,700	30'
Exhibit Hall E	64,800	7,100	3,600	3,400	30'
Exhibit Hall 1	48,600	5,300	2,700	2,700	30'
Exhibit Hall 2	16,200	1,700	900	700	30'
Exhibit Hall 3	16,200	1,700	900	700	30'
Exhibit Hall 4	64,400	6,500	3,000	3,000	30'
Exhibit Hall 5	130,300	12,000	6,000	6,000	30'

\* Hall B is not a stand-alone hall; must be used in conjunction with A or C.  
 \*\* Meeting Room(s) 155 G, 255 G, & 355 G are not stand-alone room spaces.

## Ballroom

ROOM	SQ. FT.	Theatre	Banquet	Classroom	Ceiling
Ballroom	45,000	4,900	2,900	2,500	30'
Room A	3,820	400	200	190	30'
Room B	3,820	400	200	190	30'
Room C	3,820	400	200	190	30'
Room D	3,820	400	200	190	30'
Room E	3,820	400	200	190	30'
Room F	3,820	400	200	190	30'
Room G	3,820	400	200	190	30'
Room H	3,820	400	200	190	30'
Room I	3,820	400	200	190	30'
Room J	3,820	380	200	190	30'

## Meeting Rooms (cont.)

ROOM	SQ. FT.	Theatre	Banquet	Classroom	Ceiling
Room155 A-F	24,000	2,400	1,000	1,000	15'
Room155A	2,530	260	120	120	15'
Room155B	3,240	300	150	160	15'
Room155C	3,240	300	150	160	15'
Room155D	2,530	260	120	120	15'
Room155E	3,240	300	150	160	15'
Room155F	3,240	300	150	160	15'
Room155 BCEFG**	1,230	600	550	15'	
Room250 A-F	8,300	850	500	430	20'
Room250A	1,450	120	80	80	20'
Room250B	1,470	120	80	80	20'
Room250C	1,480	120	80	80	20'
Room250D	1,300	110	60	60	20'
Room250E	1,300	110	60	60	20'
Room250F	1,300	110	60	60	20'
Room251 A-F	8,800	900	550	450	20'
Room251A	1,300	110	60	60	20'
Room251B	1,300	120	60	70	20'
Room251C	1,600	120	80	80	20'
Room251D	1,600	150	80	80	20'
Room251E	1,600	150	80	80	20'
Room251F	1,700	150	80	80	20'
Room252 A-B	980	80	50	40	12'
Room252A	490	40	20	15	12'
Room252B	490	40	20	15	12'
Room253 A-B	2,000	200	100	90	12'
Room253A	990	100	40	40	12'
Room253B	1,010	100	40	40	12'
Room254 A-C	4,500	450	240	220	20'
Room254A	1,000	100	60	40	20'
Room254B	2,500	250	120	140	20'
Room254C	1,000	100	60	40	20'
Room255 A-F	24,000	2,400	1,000	1,000	15'
Room255A	2,530	260	120	120	15'
Room255B	3,240	300	150	160	15'
Room255C	3,240	300	150	160	15'
Room255D	2,530	260	120	120	15'
Room255E	3,240	300	150	160	15'
Room255F	3,240	300	150	160	15'
Room255 BCEFG**	1,230	600	550	15'	
Room257	1,700	170	100	90	13'
Room257A		65	40	36	13'
Room257B		75	40	36	13'
Room258	1,380	140	60	84	13'
Room259	1,380	140	60	84	13'
Room260	1,700	170	100	90	13'
Room260A		65	40	36	13'
Room260B		75	40	36	13'
Room355 A-F	24,000	2,400	1,000	1,000	18'
Room355A	2,530	260	120	120	18'
Room355B	3,240	300	150	160	18'
Room355C	3,240	300	150	160	18'
Room355D	2,530	260	120	120	18'
Room355E	3,240	300	150	160	18'
Room355F	3,240	300	150	160	18'
Room355 BCEFG**	1,230	600	550	18'	

## Meeting Rooms

ROOM	SQ. FT.	Theatre	Banquet	Classroom	Ceiling
Room150 A-C	6,080	700	350	340	15'
Room150A	600	50	20	20	15'
Room150B	590	60	20	20	15'
Room150C	660	60	20	20	15'
Room150D	600	50	20	20	15'
Room150E	590	60	20	20	15'
Room150F	660	60	20	20	15'
Room150G	2,380	250	140	120	15'
Room151 A-C	6,500	700	350	330	15'
Room151A	625	50	20	20	15'
Room151B	600	60	20	20	15'
Room151C	670	60	20	20	15'
Room151D	625	50	20	20	15'
Room151E	600	60	20	20	15'
Room151F	670	60	20	20	15'
Room151G	2,710	270	140	120	15'

- - Exhibit Halls
- - Meeting Rooms
- - Ballroom
- - Public Areas
- Loading Docks
- - Escalators/Elevators/Stairs
- Facility Entrances
- P - Parking
- T - Concessions
- R - Restrooms
- M - Mother's Room (3)
- F - First Aid (2)



CALVIN L. RAMPTON  
**SALT PALACE**  
CONVENTION CENTER  
A SALT LAKE COUNTY FACILITY

100 South West Temple  
Salt Lake City, Utah 84101  
385-468-2222

[SALTPALACE.COM](http://SALTPALACE.COM)



SALT LAKE



STAKEHOLDERS



MANAGED BY:

