

PARTS

(1) Hardware



(2) Graphic printing fabric banner



STEP 01

To connect the poles according to the labellings

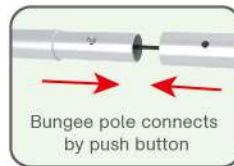

STEP 02

To use corner pieces to connect the poles to be display stand

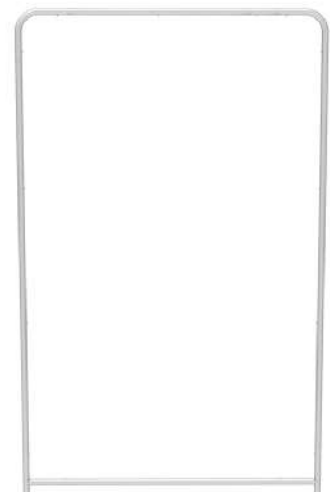
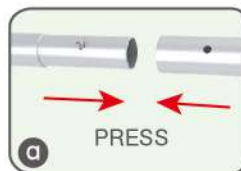
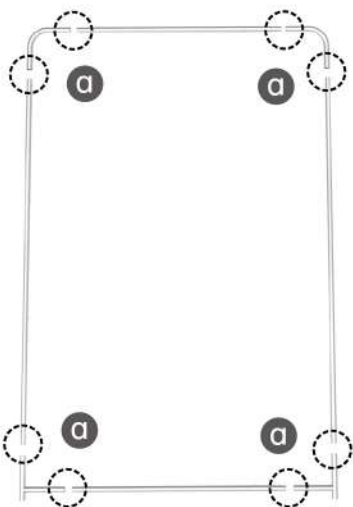

PARTS

STEP 03

To slide the fabric banner on the frame from top and zip up at bottom



STEP 04

To assemble the stand feet in position

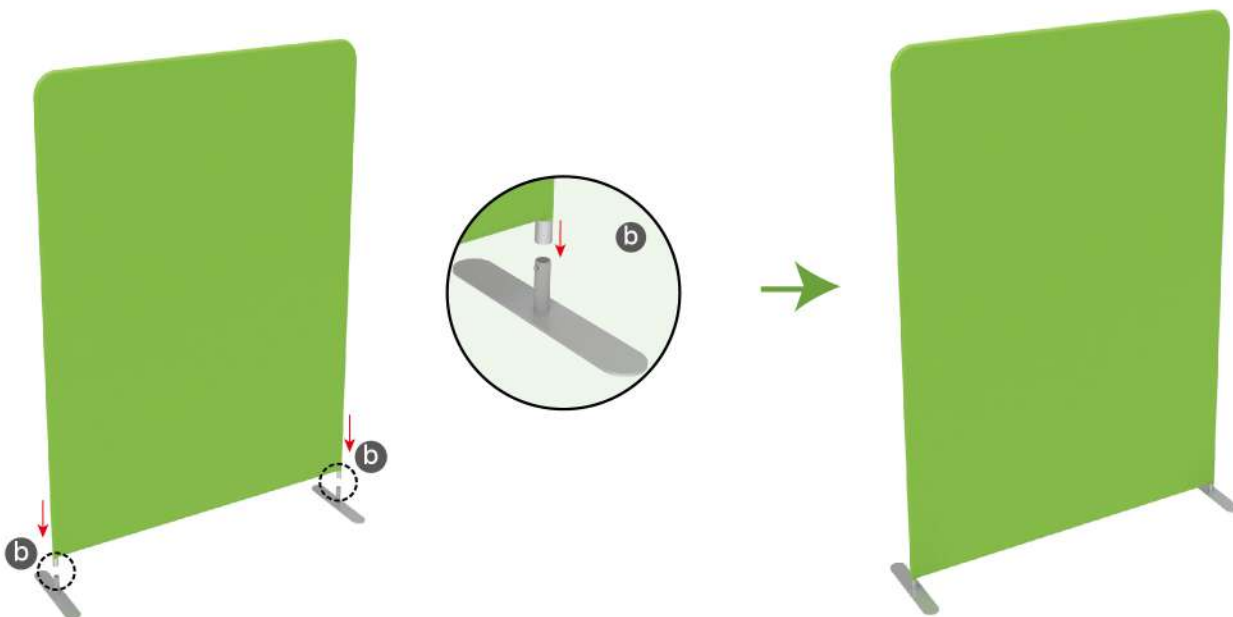

PARTS

(1) Hardware

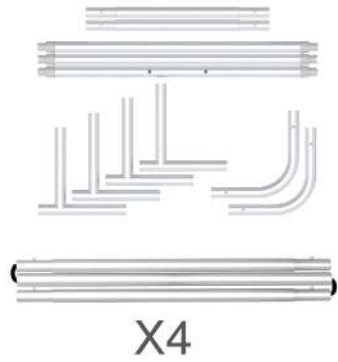

(2) Graphic printing fabric banner



STEP 01

To connect the poles according to the labellings

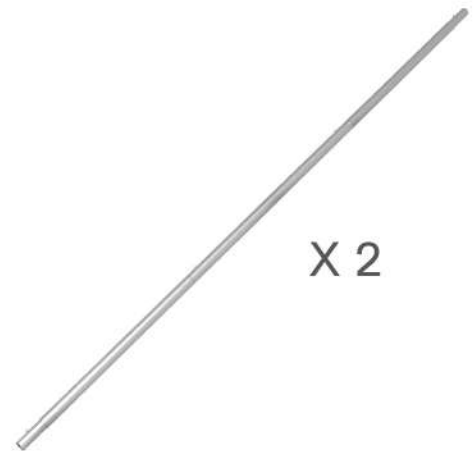
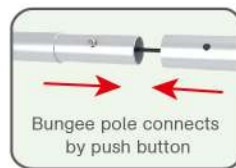
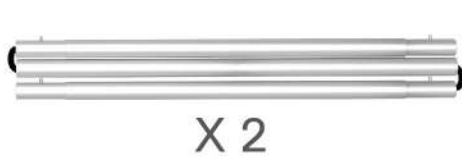

STEP 02

To use corner pieces to connect the poles to be display stand

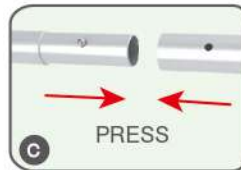
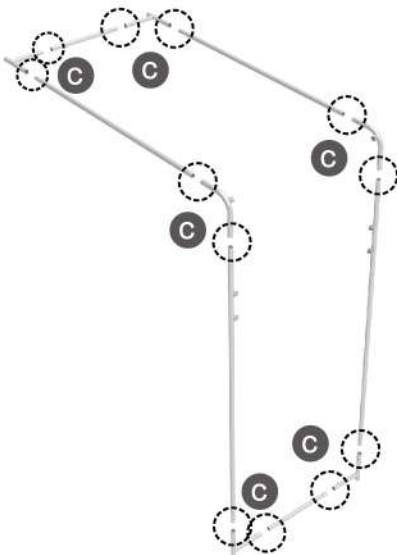

PARTS

STEP 03

To install the cross bar according to the labellings

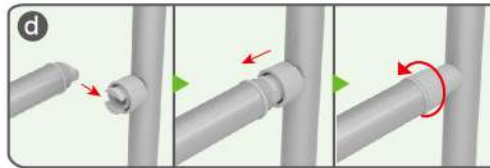
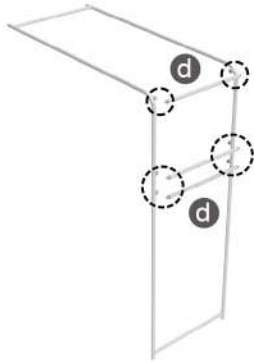

STEP 04

To Wrap the fabric banner from side to sides and zip up



STEP 05

To assemble the feet in position

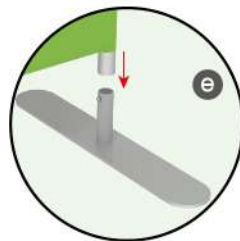
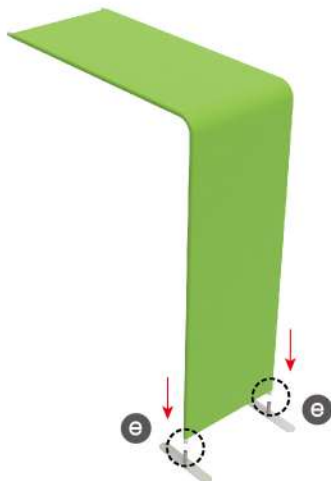

PARTS

(1) Hardware



(2) Graphic printing fabric banner



STEP 01

To connect the poles according to the labellings

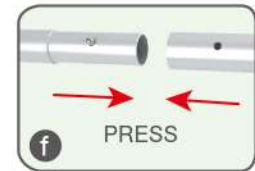
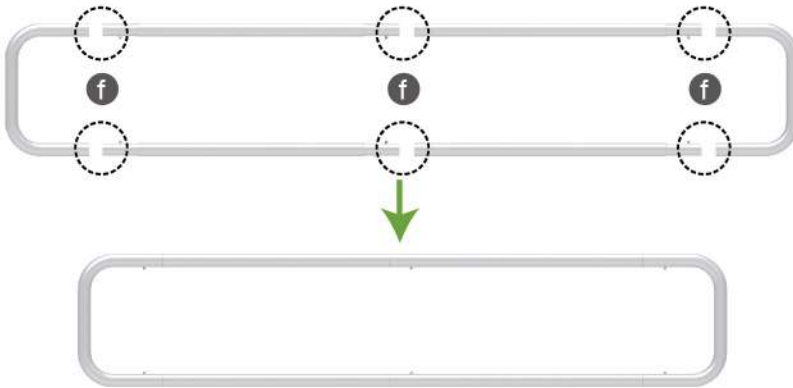

STEP 02

To wrap up the fabric banner from side to side and zip up

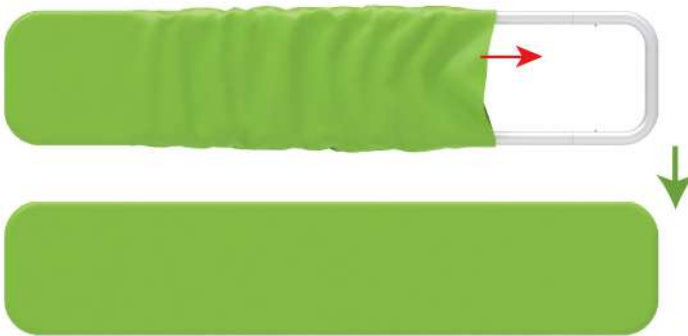

Same steps for below style of headers



PARTS

(1) Booth Set



STEP 01

To attach the Arch TV stand to the backwall and fasten the clamp by Allen key

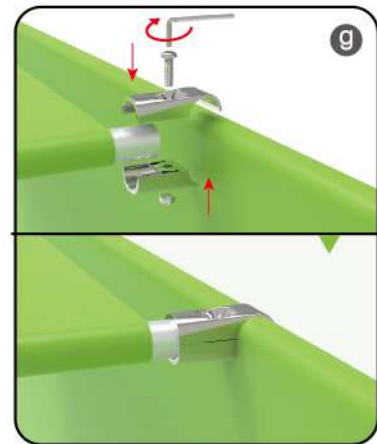

PARTS

STEP 02

To use C clip & Allen Key to fasten the header on the backwall

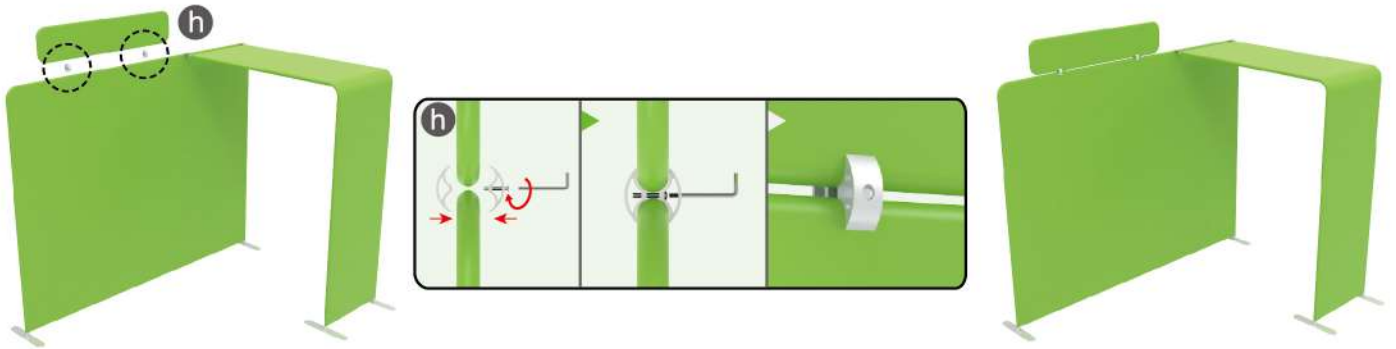

STEP 04

To install the TV mount in position

TV Mount with screw bag x 1
Allen Key x 1

