

PARTS

(1) Hardware

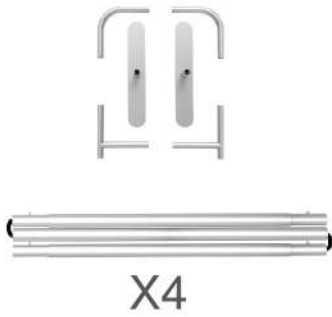

(2) Graphic printing fabric banner



(3) LED Light
Light Clips



STEP 01

To connect the poles according to the labellings

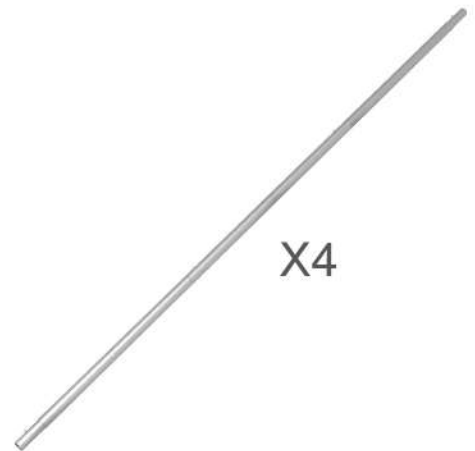
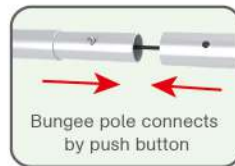
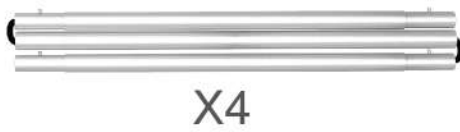

STEP 02

Connect the support poles .

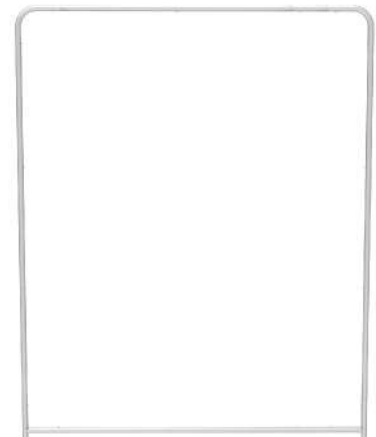
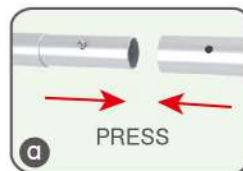
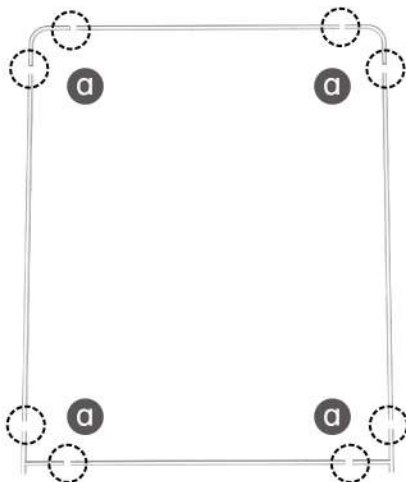

PARTS

STEP 03

To slide the fabric banner on the frame from top and zip up at bottom



STEP 04

To assemble the stand feet in position

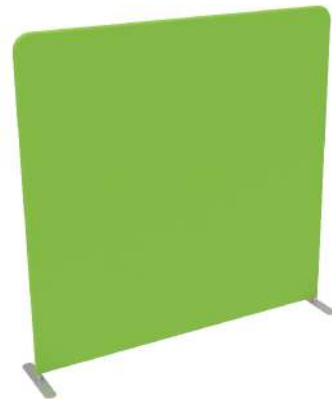
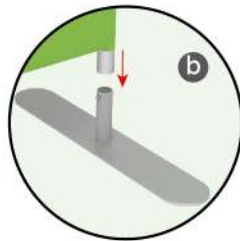
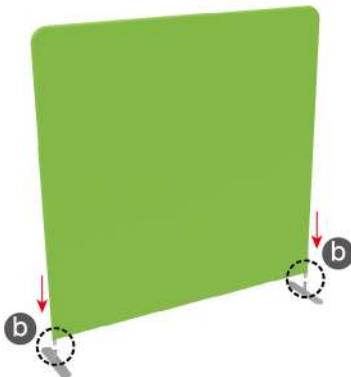

PARTS

(1) Hardware

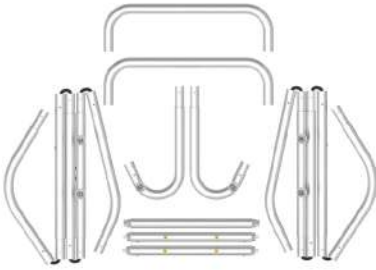

(2) Graphic printing fabric banner



(3) Shelves and Bracket x 2



(4) 1x TV rack and screw bag

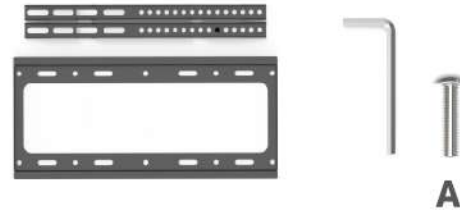

STEP 01

To connect the poles according to the labellings

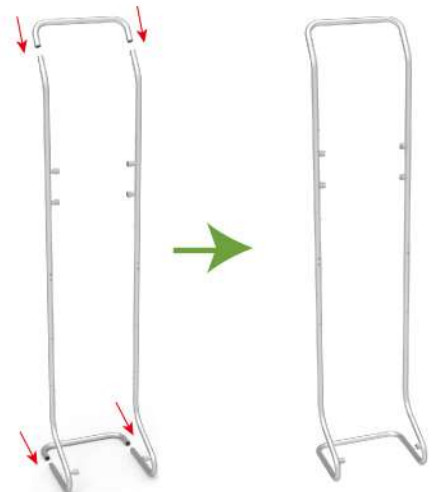
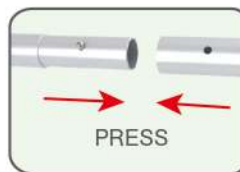
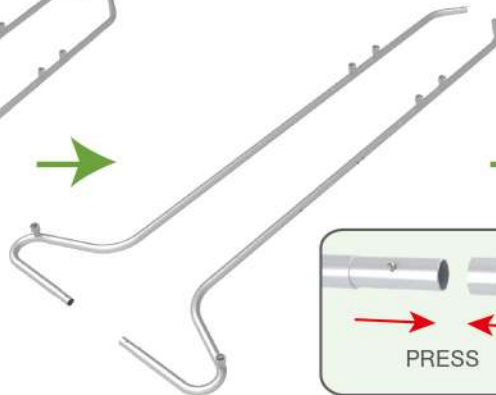
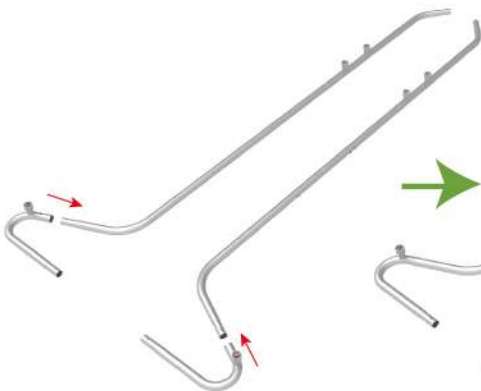
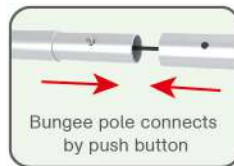

PARTS

STEP 02

To install the cross bar in position

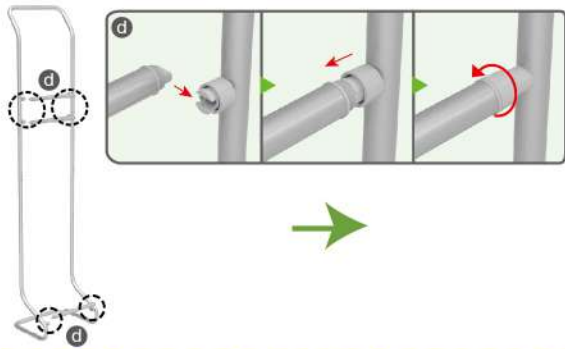

STEP 03

To slide over the fabric banner from top to bottom and zip up



STEP 04

To install the shelves by using the bracket, afterwards to install the TV mount in position

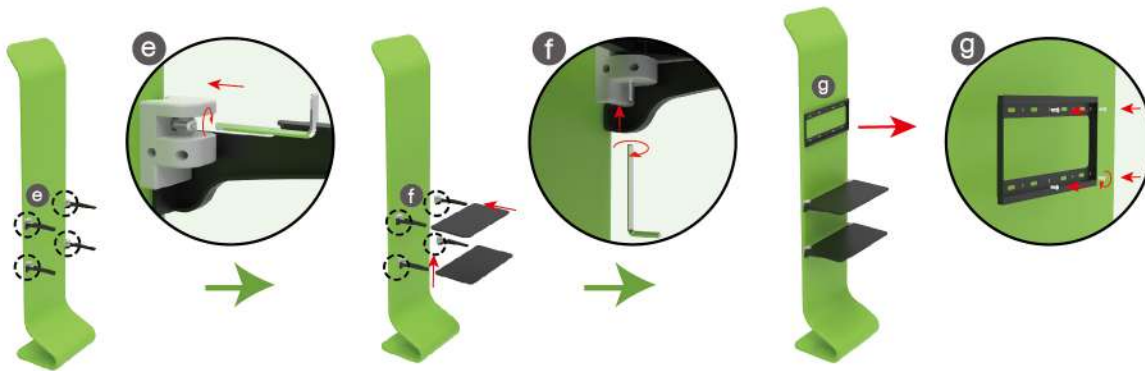

STEP 05

To install the TV in position

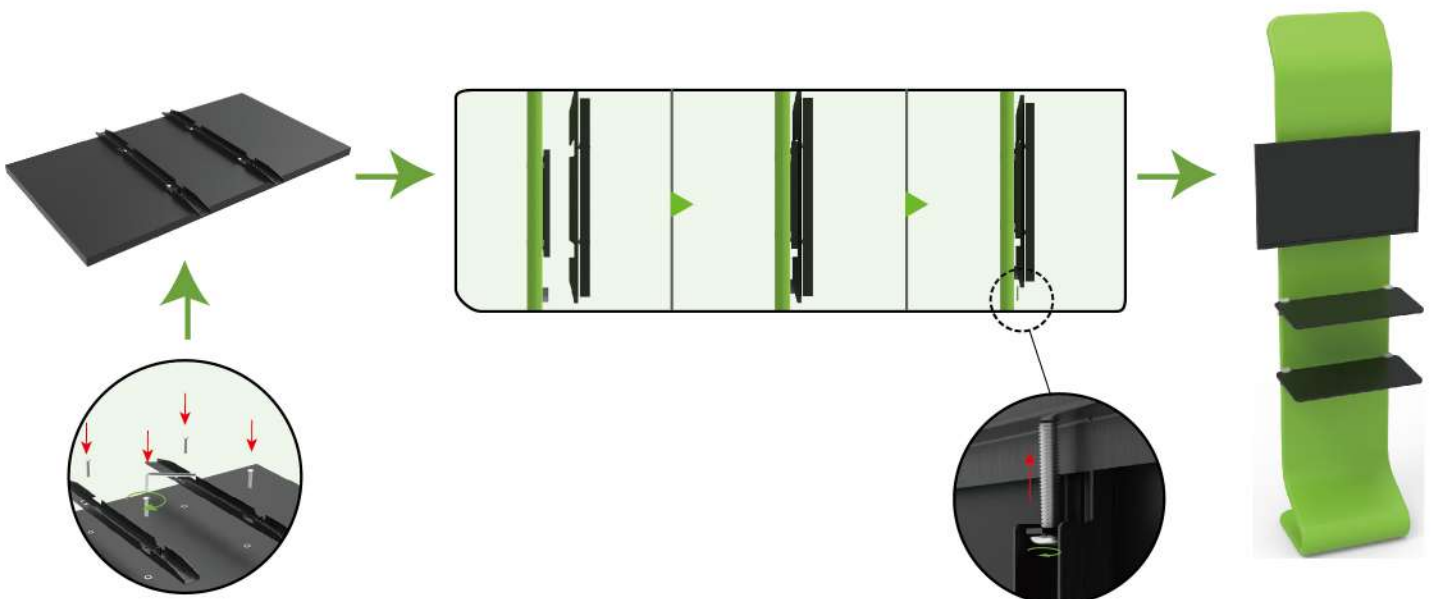

PARTS

(1) Hardware



(2) Graphic printing fabric banner



STEP 01

To connect the poles according to the labellings

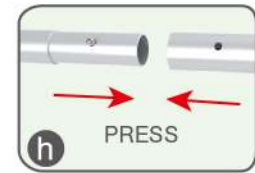
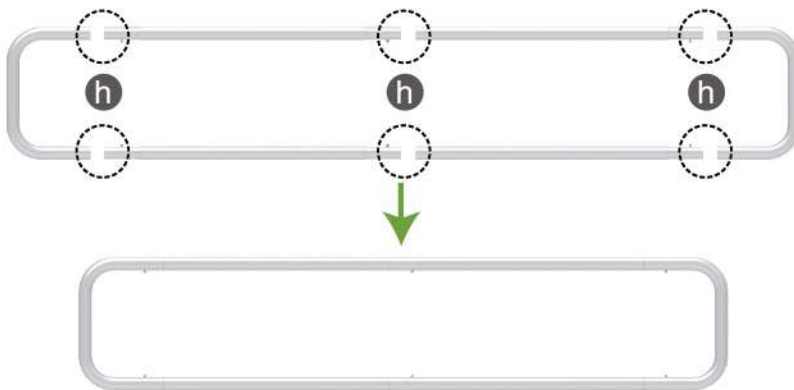

STEP 02

To slide the fabric banner on the frame from side and zip up at side

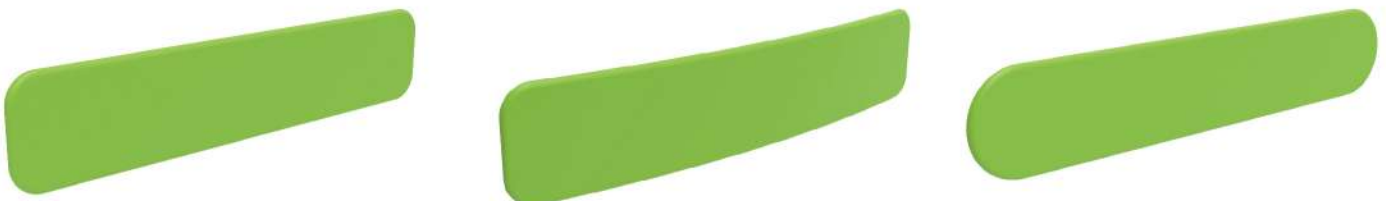
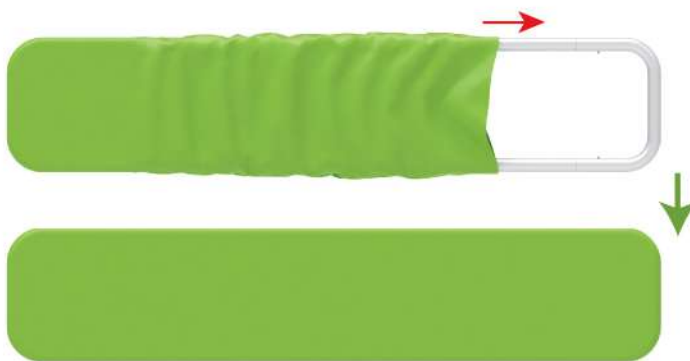

PARTS

Booth Set Assembly



(2) 180 degree C Clip. x 2
90 degree C clip x 2



STEP 01

Lie down the back wall and install the TV stand & header by using C clip
90 degree C clip for TV stand; 180 degree C clip for header

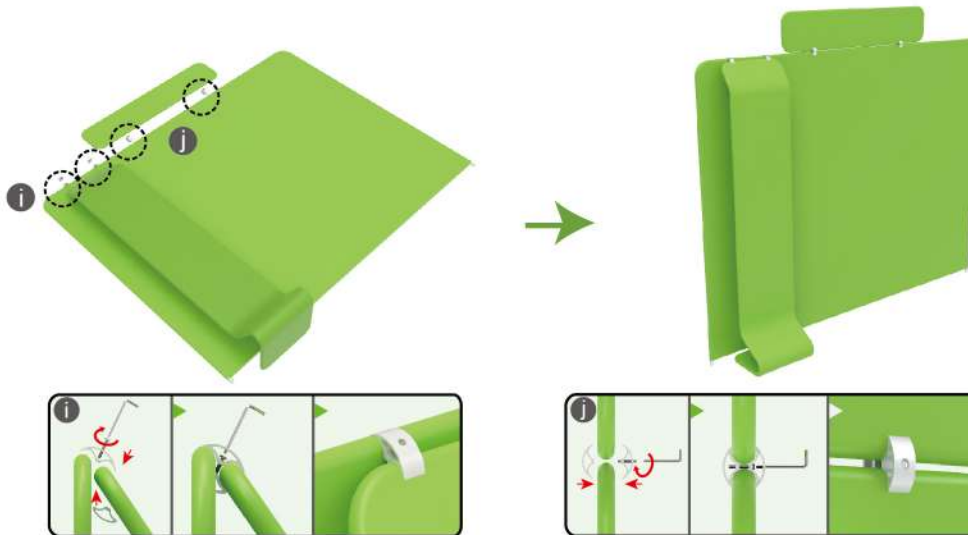

STEP 02

To assemble the stand feet in position

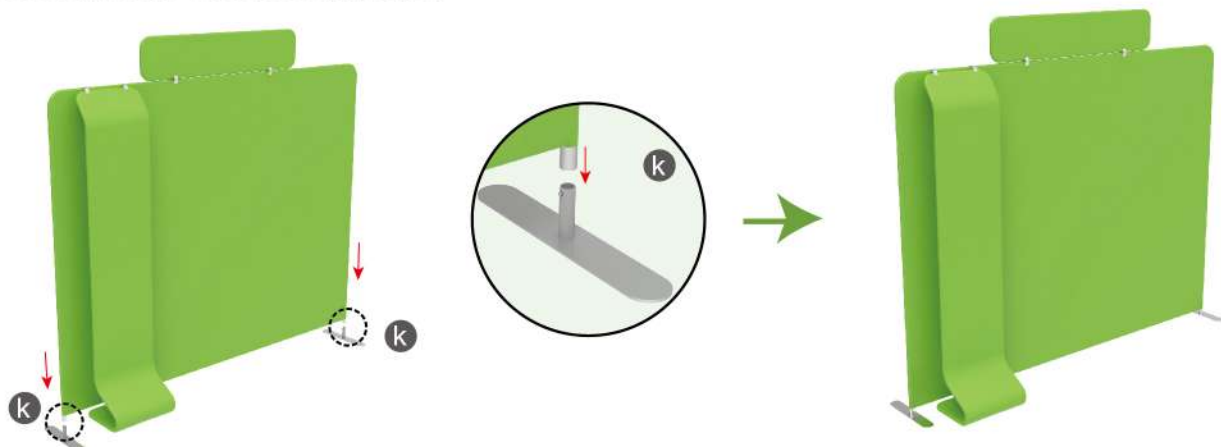

PARTS

STEP 03

To hang TV in position



STEP 04

Install LED light

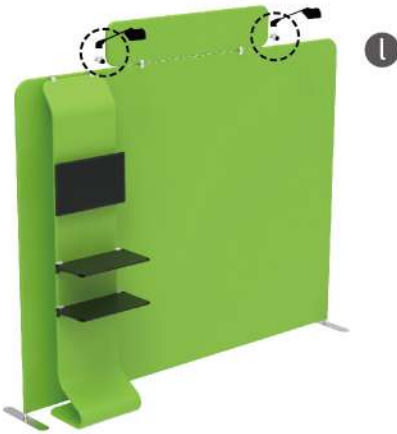

Same assembly steps for 10ft booth-G, W, 17



TF-SB-10X10-17
10x10FT-BOOTH-F



10x10FT-BOOTH-G
10x10FT-BOOTH-W